

BUTLER COUNTY ENGINEER'S OFFICE



GREGORY J. WILKENS, P.E., P.S. BUTLER COUNTY ENGINEER

- PHASE ONE - YANKEE ROAD EXTENSION
 - PHASE TWO - CINCINNATI DAYTON & YANKEE ROAD IMPROVEMENTS
LIBERTY ONE DR. (1171 LF)
 - PHASE THREE - CHILDREN'S MEDICAL OFFICE IMPROVEMENTS
YANKEE RD. LOOP EXTENSION (1558 LF)
& LIBERTY ONE DR. EXTENSION (624 LF)
LAKOTA LANE EXTENSION (1026 LF)
 - PHASE FOUR - SR 129 RAMP IMPROVEMENTS (968 LF)
- SIGNALIZED INTERSECTION

Date: 8/12/2005

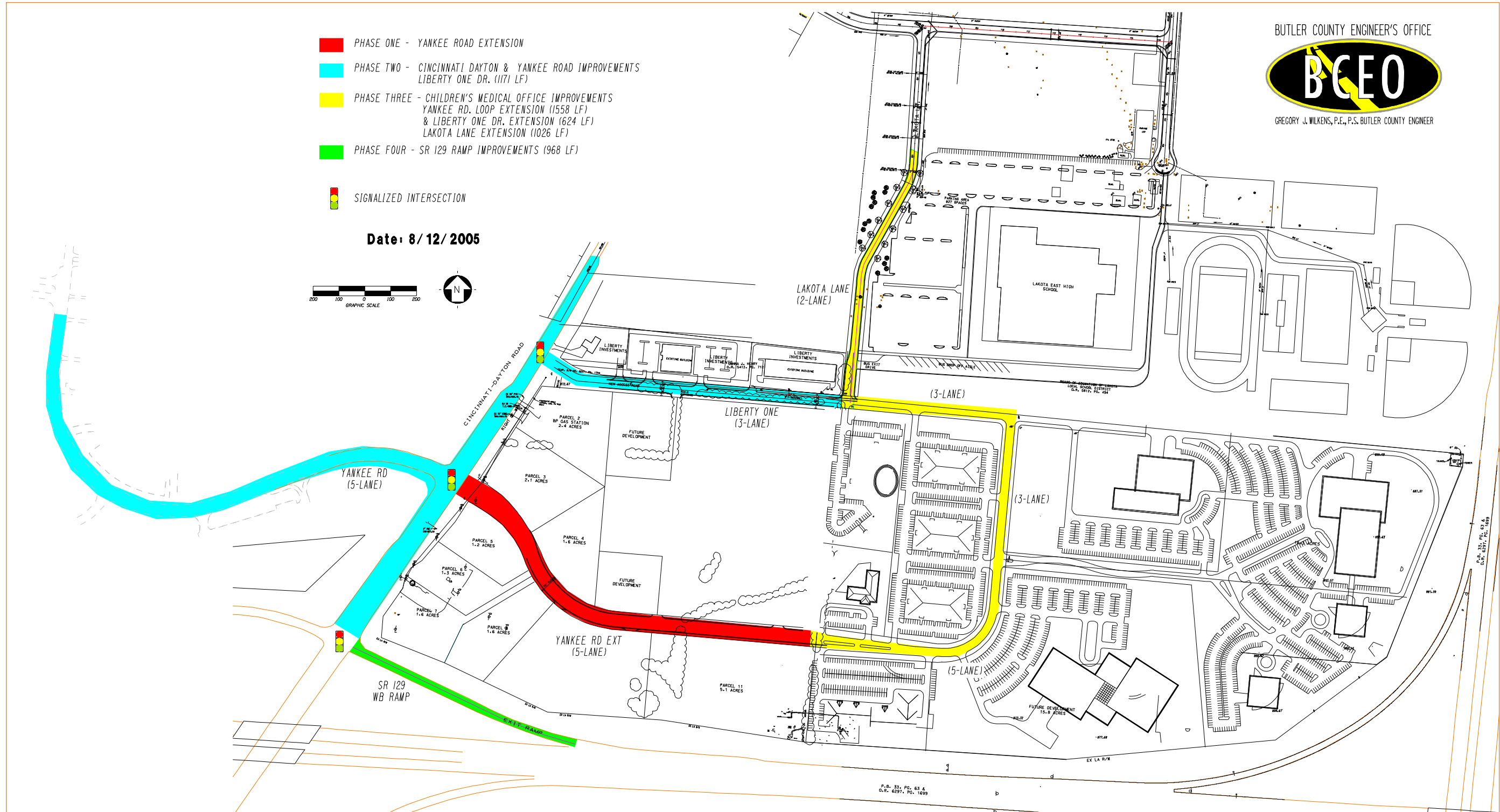
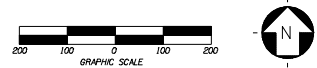

P.L. 33, P.D. 65 &
O.R. 4297, P.D. 1699

P.L. 33, P.D. 65 &
O.R. 4297, P.D. 1699