

# CONTROL MONUMENT RECORD

DATE: 3/8/99

TOWNSHIP: FAIRFIELD

SECTION: 5

TOWN: 1

RANGE: 2

COUNTY: BUTLER

STATE: OHIO

LOCATION: Monument is at the intersection of Symmes Road and McCormick Lane.

<b>Monument No:</b> 99FC56	<b>State Plane Coordinates:</b> Meters (NAD 83/86)	<b>Latitude and Longitude:</b> (NAD 83/86)
<b>Elevation:</b> Meters (NAVD 88) GPS 175.234	NORTH 152245.668 EAST 421587.554	LAT 39° 21' 10.78684" LONG 84° 34' 12.71973"

<b>Grid Scale Factor:</b> 0.999936057	<b>Convergence:</b> -1° 18' 48.89627"
---------------------------------------	---------------------------------------

<b>Azimuth to 99FC56A</b>	is 185° 33' 55" (grid)	<b>Distance is</b> 459.832 m
---------------------------	------------------------	------------------------------

**MONUMENT DESCRIPTION:**

Butler County Monument -1/2" x 30" rebar in monument (not necessarily centered). Butler County disk marked "99FC56", with center punch mark.

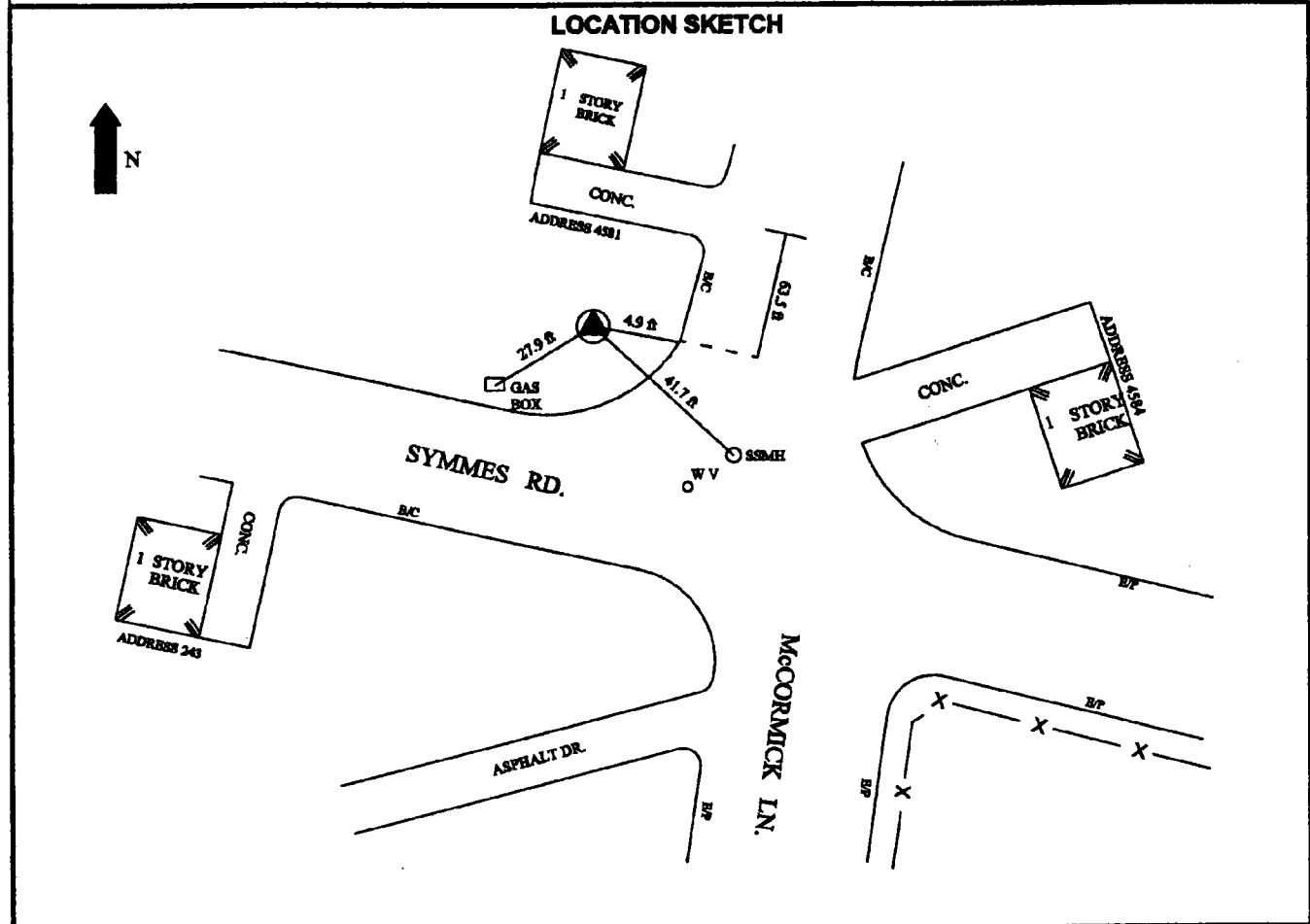

<b>DATA BY:</b> GRW AERIAL SURVEYS 801 CORPORATE DR. LEXINGTON, KY 40503 606-223-3999	<b>TYPE OF EQUIPMENT USED:</b> Trimble 4000SSI dual frequency receivers with compact L1/L2 antennae with ground plane	<b>SHEET NO.</b>  <b>42</b>
---	--	-----------------------------------