

CONTROL MONUMENT RECORD

DATE: 10/27/94

TOWNSHIP: ROSS

SECTION: 27

TOWN: 3 N

RANGE: 2 E

COUNTY: BUTLER

STATE: OHIO

LOCATION: Monument is on the west side of S.R. 128, 1/4 mile south of Millville Road, near Ross High School.

Monument No: 99FC57 (2089)	State Plane Coordinates: Meters (NAD 83/88)	Latitude and Longitude: (NAD 83/88)
Elevation: Meters (NAVD 88) GPS 176.930	NORTH 150060.634 EAST 416251.995	LAT 39° 19' 55.92448" LONG 84° 37' 53.36321"

Grid Scale Factor: 0.999936320

Convergence: -1° 21' 08.89887"

Azimuth to 99FC57A

is 203° 59' 37" (grid)

Distance is 798.790 m

MONUMENT DESCRIPTION:

Butler County Monument -1/2" x 30" rebar in monument (not necessarily centered). Butler County disk marked "99FC57", with center punch mark.

LOCATION SKETCH

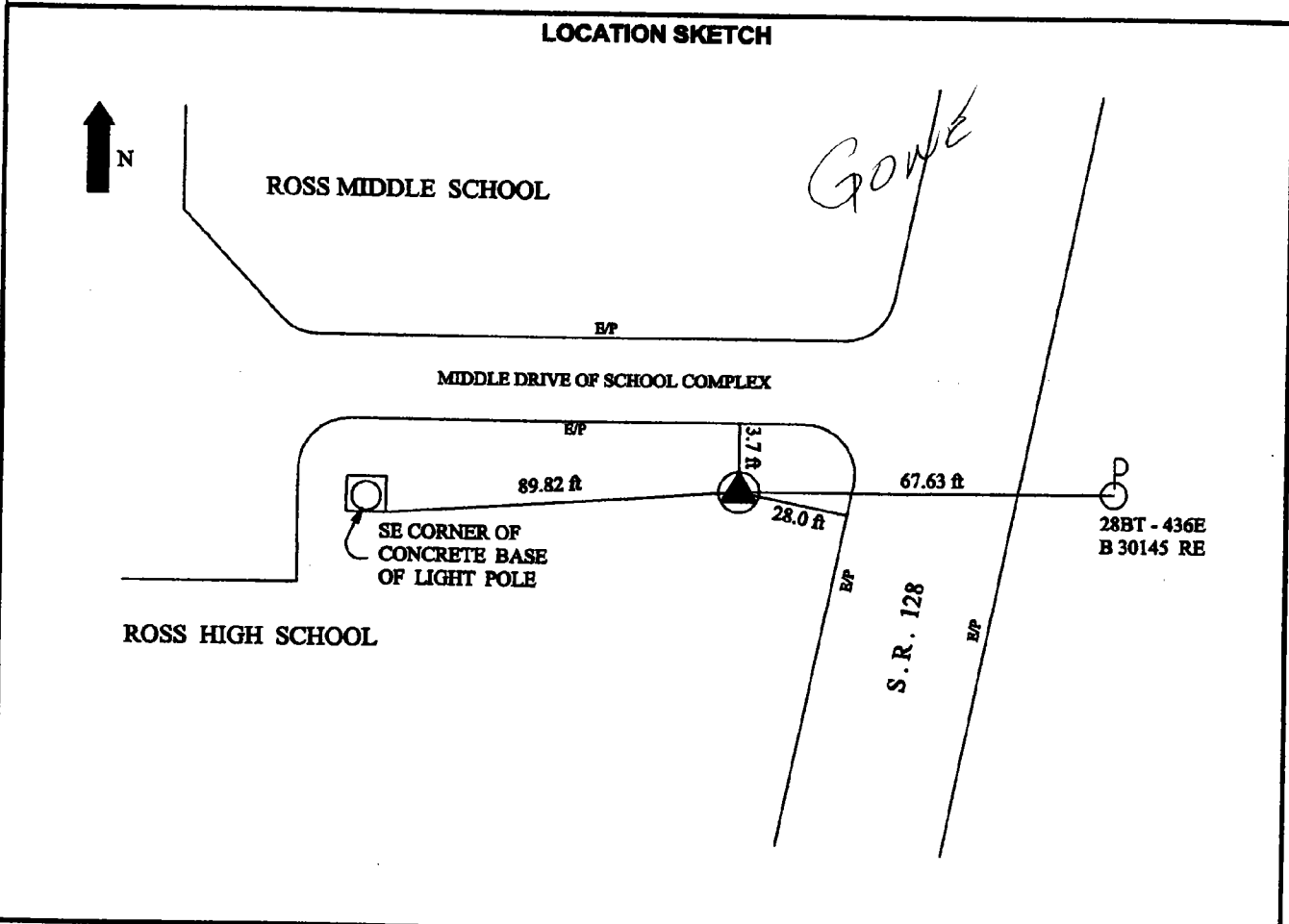

DATA BY:
 GRW AERIAL SURVEYS
 801 CORPORATE DR.
 LEXINGTON, KY 40503
 606-223-3999

TYPE OF EQUIPMENT USED:
 Trimble 4000SSI dual frequency receivers with compact L1/L2 antennae with ground plane

SHEET NO.
44