

CONTROL MONUMENT RECORD

DATE: 3 / 19 / 99

TOWNSHIP: FAIRFIELD

SECTION: 6

TOWN: 3

RANGE: 3

COUNTY: BUTLER

STATE: OHIO

LOCATION: Monument is on the south side of Columbia Road, 1 mile west of the interstecction of S.R. 128.

| | | |
|--|--|--|
| Monument No: 99FC59 | State Plane Coordinates: Meters (NAD 83/86) NORTH 156575.992 EAST 419976.025 | Latitude and Longitude: (NAD 83/86) LAT 39° 23' 29.96920" LONG 84° 35' 24.19941" |
| Elevation: Meters (NAVD 88) GPS 222.232 | | |

Grid Scale Factor: 0.999935916

Convergence: -1° 19' 34.25153"

Azimuth to 99FC59A

is 90° 41' 41" (grid)

Distance is 225.728 m

MONUMENT DESCRIPTION:

Butler County Monument -1/2" x 30" rebar in monument (not necessarily centered). Butler County disk marked "99FC59", with center punch mark.

LOCATION SKETCH

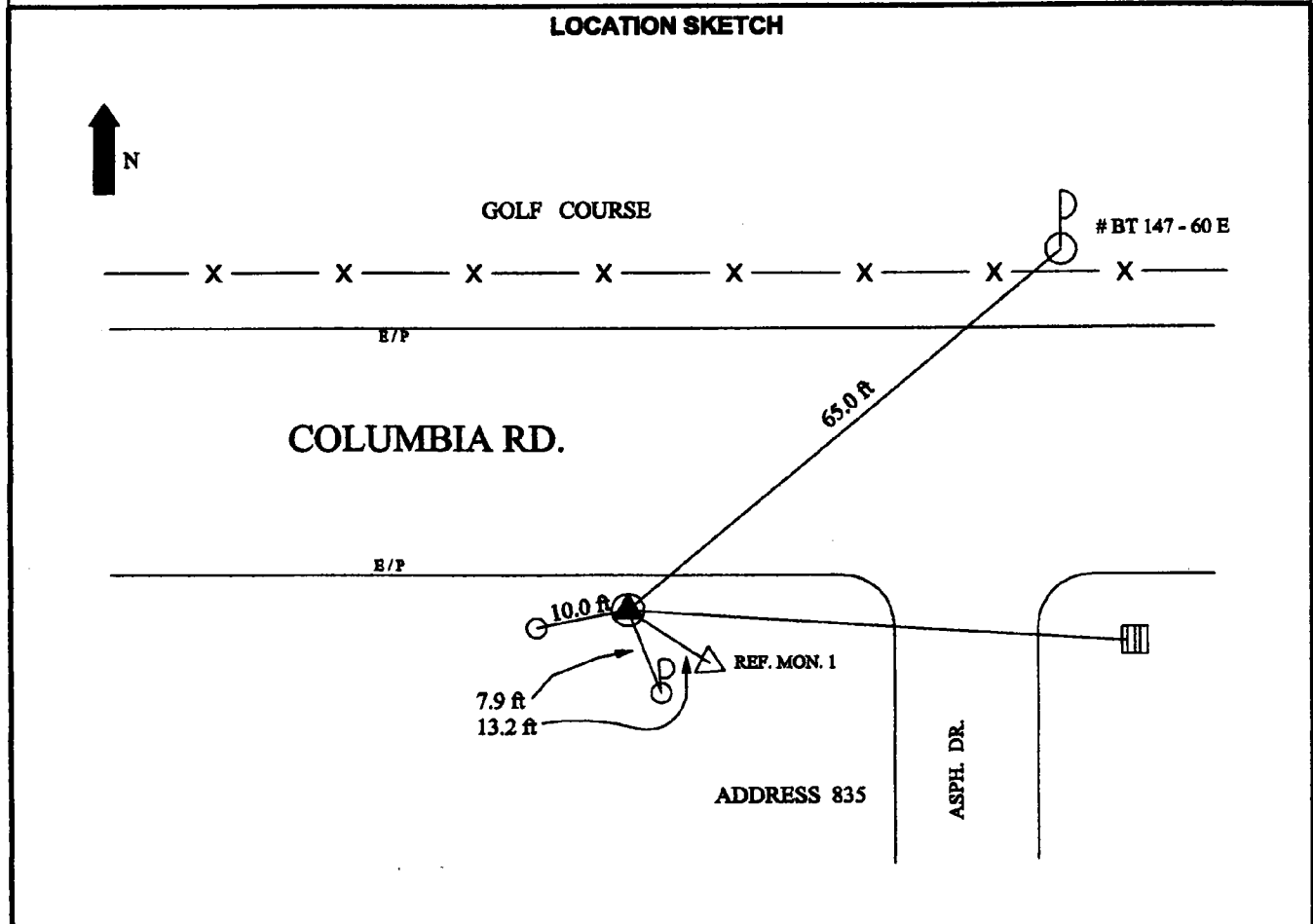

| | | |
|---|--|---|
| DATA BY: GRW AERIAL SURVEYS 801 CORPORATE DR. LEXINGTON, KY 40503 606-223-3999 | TYPE OF EQUIPMENT USED: Trimble 4000SSI dual frequency receivers with compact L1/L2 antennae with ground plane | SHEET NO. 48 |
|---|--|---|