

# CONTROL MONUMENT RECORD

DATE: 3/3/99

TOWNSHIP: FAIRFIELD

SECTION: 29

TOWN: 2

RANGE: 2

COUNTY: BUTLER

STATE: OHIO

**LOCATION:** Monument is at the intersection of Bobmeyer Road and East Airport Drive (B.F.I. Drive), 100 +/- north of the Norfolk and Western Rail Line.

<b>Monument No:</b> 99FC60A	<b>State Plane Coordinates:</b> Meters (NAD 83/86)	<b>Latitude and Longitude:</b> (NAD 83/86)
<b>Elevation:</b> Meters (NAVD 88) GPS 186.120	NORTH 152925.372 EAST 425567.210	LAT 39° 21' 35.74819" LONG 84° 31' 27.17257"

**Grid Scale Factor:** 0.999935998

**Convergence:** -1° 17' 03.85336"

**Azimuth to HOGAN AZI MK** is 329° 27' 19" (grid)

**Distance is** 675.148 m

**MONUMENT DESCRIPTION:**

Butler County Monument -1/2" x 30" rebar in monument (not necessarily centered). Butler County disk marked "99FC60A", with center punch mark.

**LOCATION SKETCH**

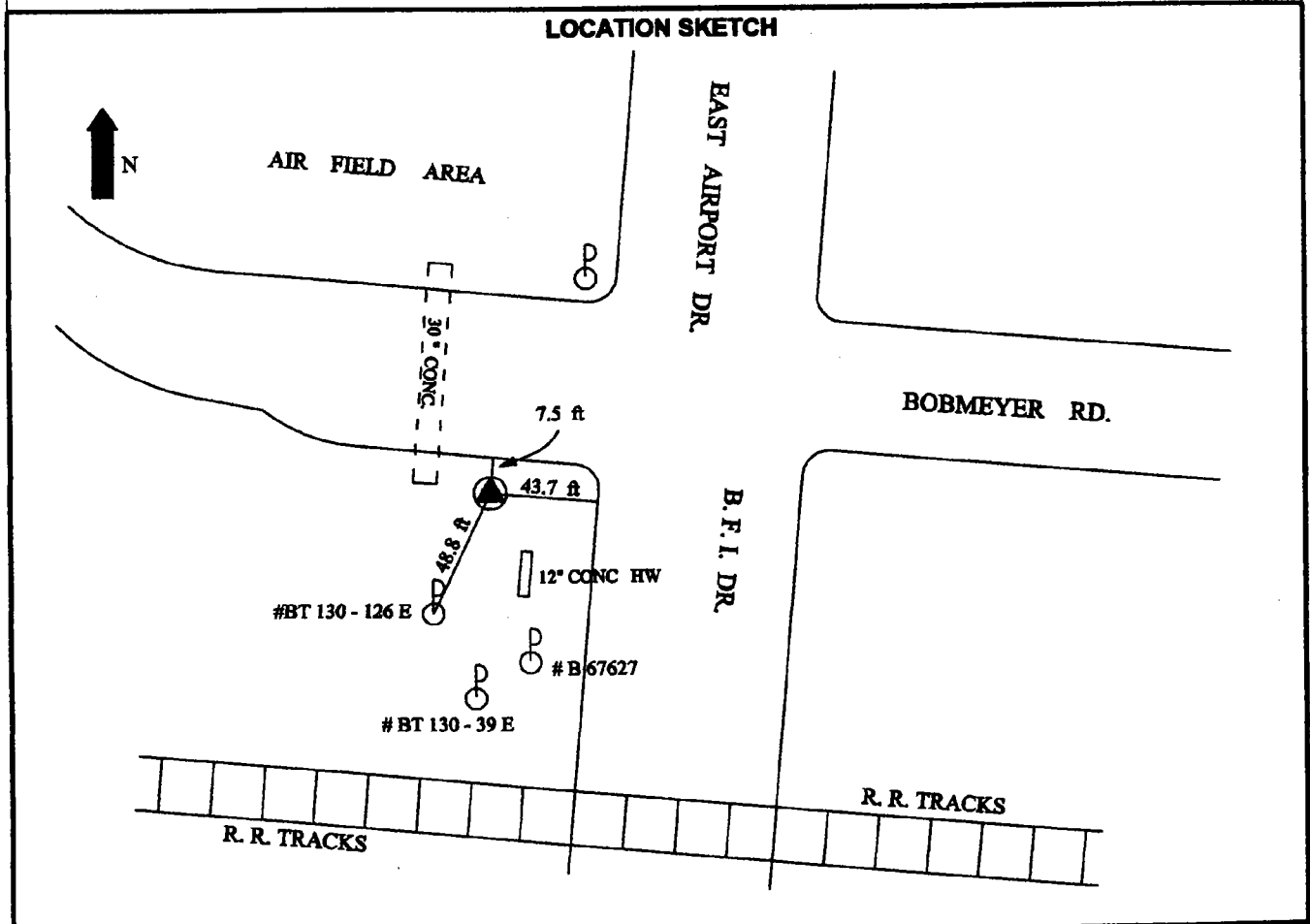

<b>DATA BY:</b> GRW AERIAL SURVEYS 801 CORPORATE DR. LEXINGTON, KY 40503 606-223-3999	<b>TYPE OF EQUIPMENT USED:</b> Trimble 4000SSI dual frequency receivers with compact L1/L2 antennae with ground plane	<b>SHEET NO.</b>  <b>51</b>
---	--	-----------------------------------