

CONTROL MONUMENT RECORD

DATE: 10/27/94

TOWNSHIP: ROSS

SECTION: 15

TOWN: 3 N

RANGE: 2 E

COUNTY: BUTLER

STATE: OHIO

LOCATION: Monument is on the southwest side of U.S. 27 (Ross Millville Rd), 1/4 mile northwest of the intersection of Hamilton New London Road.

Monument No: 99FC58 (2081)	State Plane Coordinates: Meters (NAD 83/86)	Latitude and Longitude: (NAD 83/86)
Elevation: Meters (NAVD 88) GPS 181.579	NORTH 153359.281 EAST 414731.682	LAT 39° 21' 41.69439" LONG 84° 39' 00.10729"

Grid Scale Factor: 0.999935986	Convergence: -1° 21' 51.24929"
---------------------------------------	---------------------------------------

Azimuth to 99FC58A	is 130° 58' 00" (grid)	Distance is 548.308 m
---------------------------	-------------------------------	------------------------------

MONUMENT DESCRIPTION:

Butler County Monument -1/2" x 30" rebar in monument (not necessarily centered). Butler County disk marked "99FC58", with center punch mark.

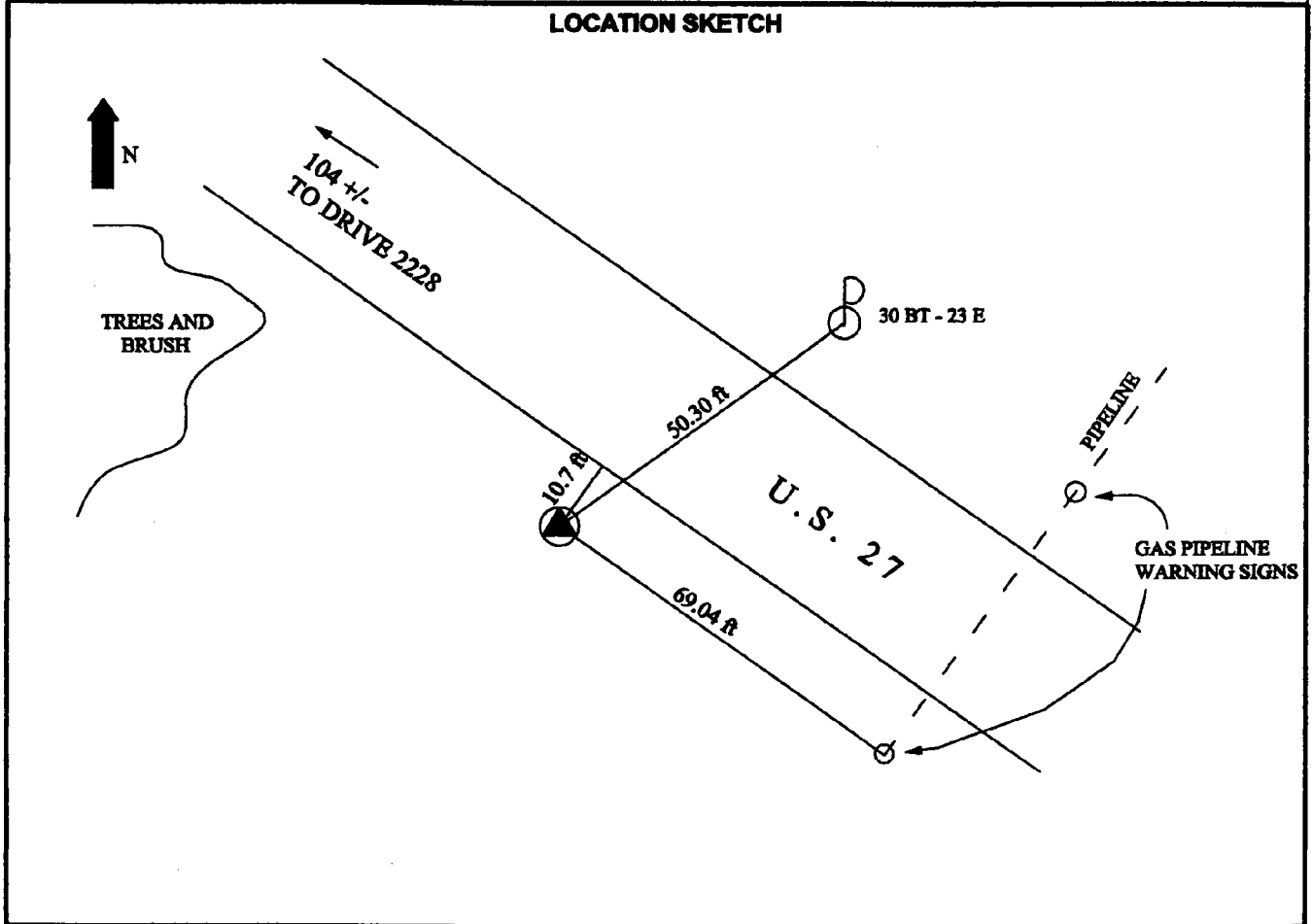

DATA BY: GRW AERIAL SURVEYS 801 CORPORATE DR. LEXINGTON, KY 40503 606-223-3999	TYPE OF EQUIPMENT USED: Trimble 4000SSI dual frequency receivers with compact L1/L2 antennae with ground plane	SHEET NO. <b style="font-size: 1.5em;">46
---	--	---