

# CONTROL MONUMENT RECORD

DATE: 3 / 19 / 99

TOWNSHIP: FAIRFIELD

SECTION: 6

TOWN: 3

RANGE: 3

COUNTY: BUTLER

STATE: OHIO

LOCATION: Monument is on the south side of Columbia Road, 1 mile west of the interstecion of S.R. 128.

<b>Monument No:</b> 99FC59	<b>State Plane Coordinates:</b> Meters (NAD 83/86)  NORTH 156575.992 EAST 419976.025	<b>Latitude and Longitude:</b> (NAD 83/86)  LAT 39° 23' 29.96920" LONG 84° 35' 24.19941"
<b>Elevation:</b> Meters (NAVD 88) GPS 222.232		

Grid Scale Factor: 0.999935916

Convergence: -1° 19' 34.25153"

Azimuth to 99FC59A

is 90° 41' 41" (grid)

Distance is 225.728 m

### MONUMENT DESCRIPTION:

Butler County Monument -1/2" x 30" rebar in monument (not necessarily centered). Butler County disk marked "99FC59", with center punch mark.

### LOCATION SKETCH

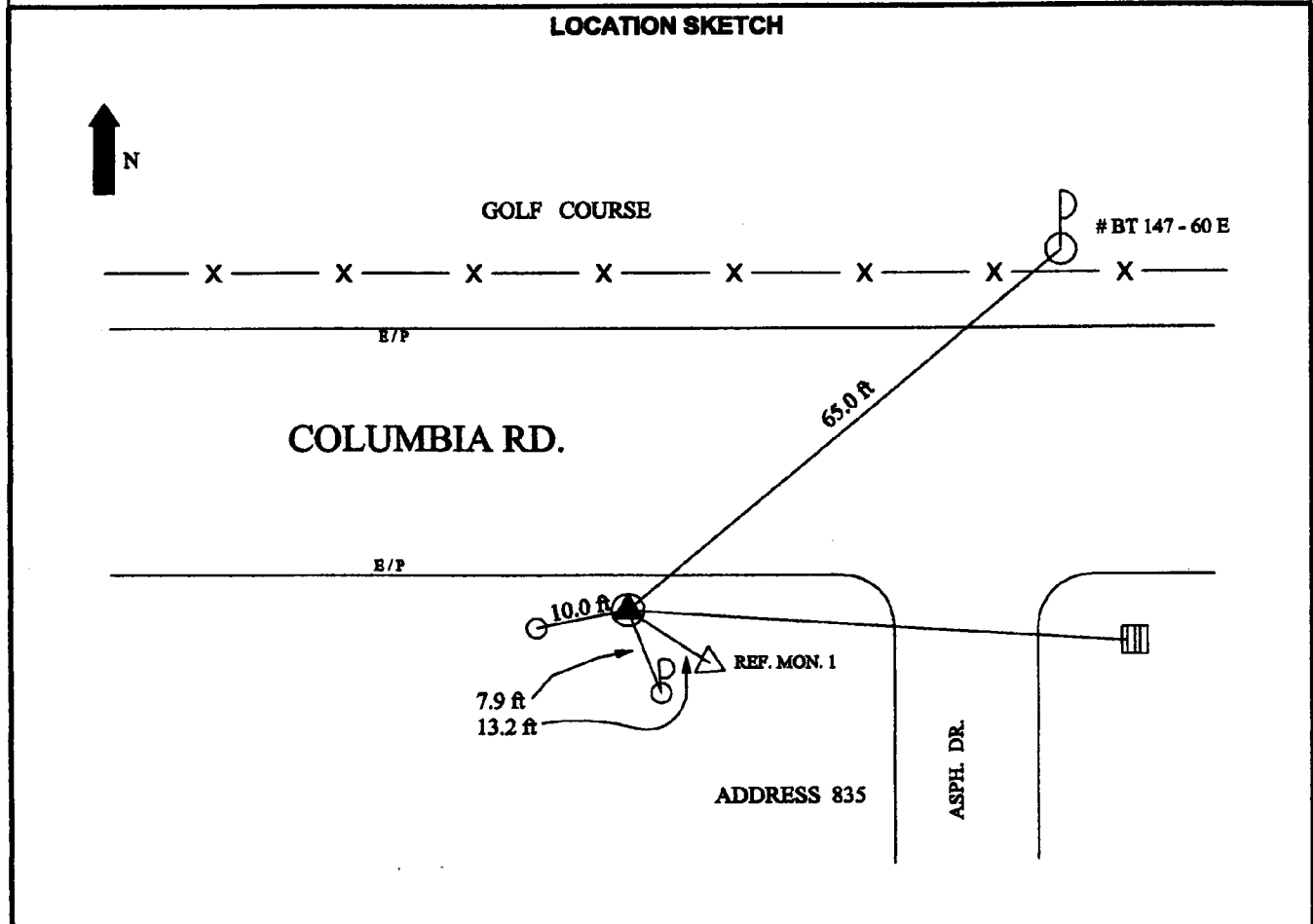

**DATA BY:**  
GRW AERIAL SURVEYS  
801 CORPORATE DR.  
LEXINGTON, KY 40503  
606-223-3999

### TYPE OF EQUIPMENT USED:

Trimble 4000SSI dual frequency receivers with compact L1/L2 antennae with ground plane

**SHEET NO.**  
**48**