

CONTROL MONUMENT RECORD

DATE: 3/9/99

TOWNSHIP: LIBERTY

SECTION: 8

TOWN: 3

RANGE: 3

COUNTY: BUTLER

STATE: OHIO

LOCATION: Monument is at the intersection of Butler Warren County Line Road and Millikin Road (Brewer Road).

Monument No: 99FC62	State Plane Coordinates: Meters (NAD 83/86) NORTH 156785.215 EAST 441251.236	Latitude and Longitude: (NAD 83/86) LAT 39° 23' 51.77671" LONG 84° 20' 35.43241"
Elevation: Meters (NAVD 88) GPS 265.389		

Grid Scale Factor: 0.999935935	Convergence: -1° 10' 10.31150"
---------------------------------------	---------------------------------------

Azimuth to 99FC62A	is 185° 54' 57" (grid)	Distance is 838.280 m
---------------------------	------------------------	------------------------------

MONUMENT DESCRIPTION:

Butler County Monument -1/2" x 30" rebar in monument (not necessarily centered). Butler County disk marked "99FC62", with center punch mark.

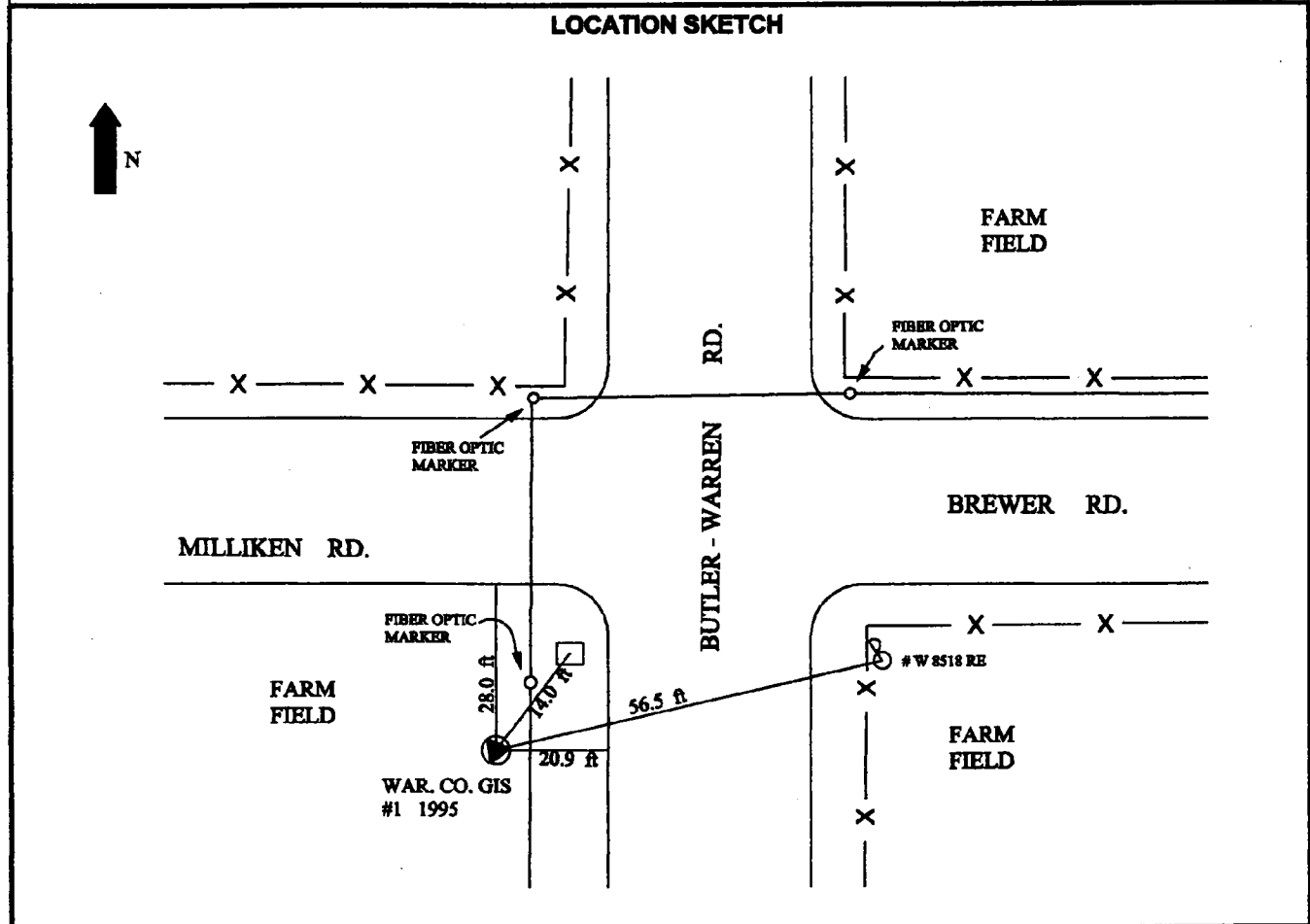

DATA BY: GRW AERIAL SURVEYS 801 CORPORATE DR. LEXINGTON, KY 40503 606-223-3999	TYPE OF EQUIPMENT USED: Trimble 4000SSI dual frequency receivers with compact L1/L2 antennae with ground plane	SHEET NO. 54
---	--	---