

# CONTROL MONUMENT RECORD

DATE: 3/11/99

TOWNSHIP: LIBERTY

SECTION: 8

TOWN: 3

RANGE: 3

COUNTY: BUTLER

STATE: OHIO

LOCATION: Monument is at the intersection of Butler Warren County Line Road and Princeton Road.

<b>Monument No:</b> 99FC62A	<b>State Plane Coordinates:</b> Meters (NAD 83/86)	<b>Latitude and Longitude:</b> (NAD 83/86)
<b>Elevation:</b> Meters (NAVD 88) GPS 263.039	NORTH 155951.176  EAST 441167.022	LAT 39° 23' 24.68054"  LONG 84° 20' 38.23964"

<b>Grid Scale Factor:</b> 0.999935913	<b>Convergence:</b> -1° 10' 12.09274"
---------------------------------------	---------------------------------------

<b>Azimuth to 99FC62</b>	<b>is</b> 5° 45' 57" (grid)	<b>Distance is</b> 838.280 m
--------------------------	-----------------------------	------------------------------

**MONUMENT DESCRIPTION:**

Butler County Monument -1/2" x 30" rebar in monument (not necessarily centered). Butler County disk marked "99FC62A", with center punch mark.

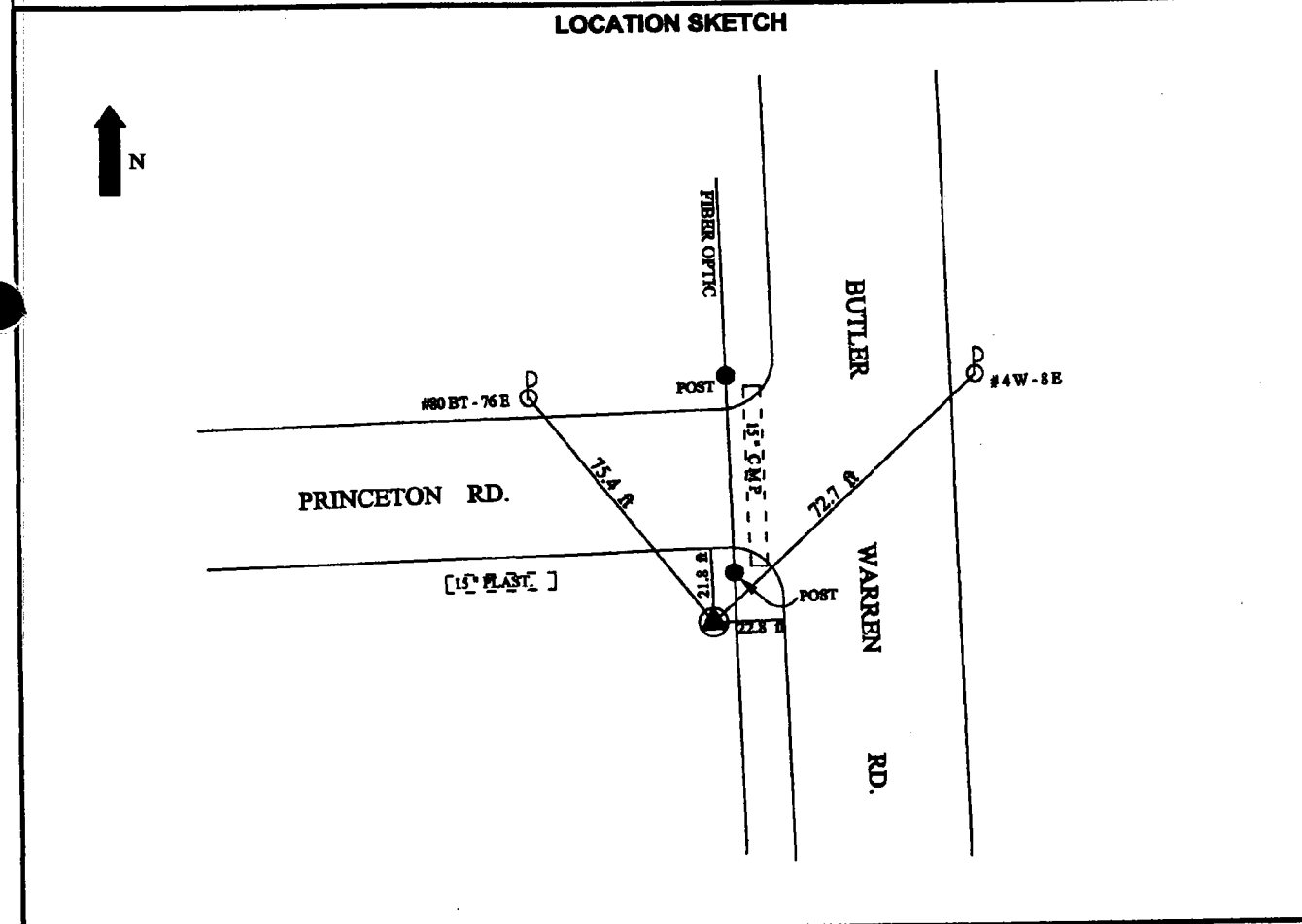

<b>DATA BY:</b> GRW AERIAL SURVEYS 801 CORPORATE DR. LEXINGTON, KY 40503 606-223-3999	<b>TYPE OF EQUIPMENT USED:</b> Trimble 400SSI dual frequency receivers with compact L1/L2 antennae with ground plane	<b>SHEET NO.</b>  <b>55</b>
---	---	-----------------------------------