

# CONTROL MONUMENT RECORD

DATE: 3 / 18 / 99

TOWNSHIP: FAIRFIELD

SECTION: 15

TOWN: 2

RANGE: 3

COUNTY: BUTLER

STATE: OHIO

LOCATION: Monument is on the north side of S.R. 4, 0.4 mi. west of the intersection of Liberty Fairfield Road.

<b>Monument No:</b> 99FC63A	<b>State Plane Coordinates:</b> Meters (NAD 83/86)  NORTH 158874.402 EAST 429342.792	<b>Latitude and Longitude:</b> (NAD 83/86)  LAT 39° 24' 51.33058" LONG 84° 28' 54.94759"
<b>Elevation:</b> Meters (NAVD 88) GPS 223.017		

<b>Grid Scale Factor:</b> 0.999936043	<b>Convergence:</b> -1° 15' 27.26364"
---------------------------------------	---------------------------------------

<b>Azimuth to 99FC63</b>	is 249° 08' 06" (grid)	<b>Distance is</b> 881.369 m
--------------------------	------------------------	------------------------------

**MONUMENT DESCRIPTION:**  
Butler County Monument -1/2" x 30" rebar in monument (not necessarily centered). Butler County disk marked "99FC63A", with center punch mark.

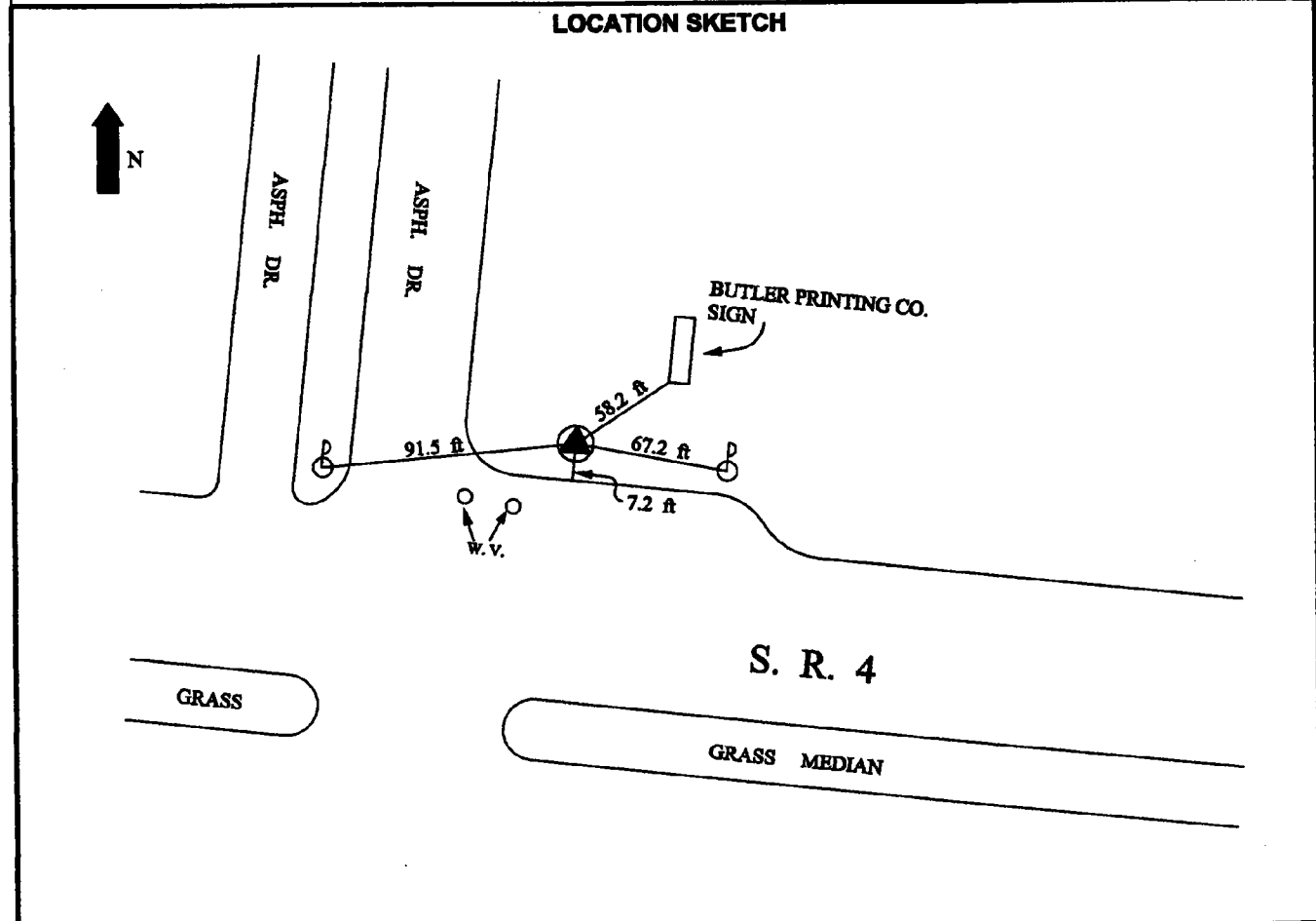

<b>DATA BY:</b> GRW AERIAL SURVEYS 801 CORPORATE DR. LEXINGTON, KY 40503 606-223-3999	<b>TYPE OF EQUIPMENT USED:</b> Trimble 4000SSI dual frequency receivers with compact L1/L2 antennae with ground plane	<b>SHEET NO.</b>  <b>57</b>
---	--	-----------------------------------