



March 3, 2022

**Contract 2022-11
Hamilton Mason Road and Mauds Hughes Road Intersection
Improvements
PID#110993
Addendum 2**

- 1.** Add off site detour plan.
- 2.** Add 2 Each, 638E900001 Abandoned Water Service At Main.

Clarification

Q1. Do structures get demolished that are not shown on the plans for parcel D2010-017.000-11.

A1. Yes, see special note in proposal: Item 202 Building Demolished APP.

Q2. Please confirm that the waterline running down Hamilton Mason Road will require LSM backfill once aggregate backfill is 1 FT above the pipe.

A2. Yes, see special note in proposal: Roadway LSM 50 Backfill Requirements.

Q3. Please confirm that from STA 209+82.83 until the tie in at 212+57 this is just a resurfacing area. LSM fill will come to the top of subgrade then asphalt resurfacing will be completed at the end of the job as this portion of the waterline is in the existing road bed.

A3. Yes, match existing pavement section.

Q4. What are the APP Catch Basins No. 3 & 3A?

A4. See note on page 7 of the construction drawings. All APP Catch Basin No. 3 & 3A are Modified per BCEO standard drawing C-7 and C-9.

Revised "Schedule Of Prices" Attached

Please e-mail or call our office when you have received this Addendum.

taylor@m@bceo.org

Melissa Taylor; 513-785-4115

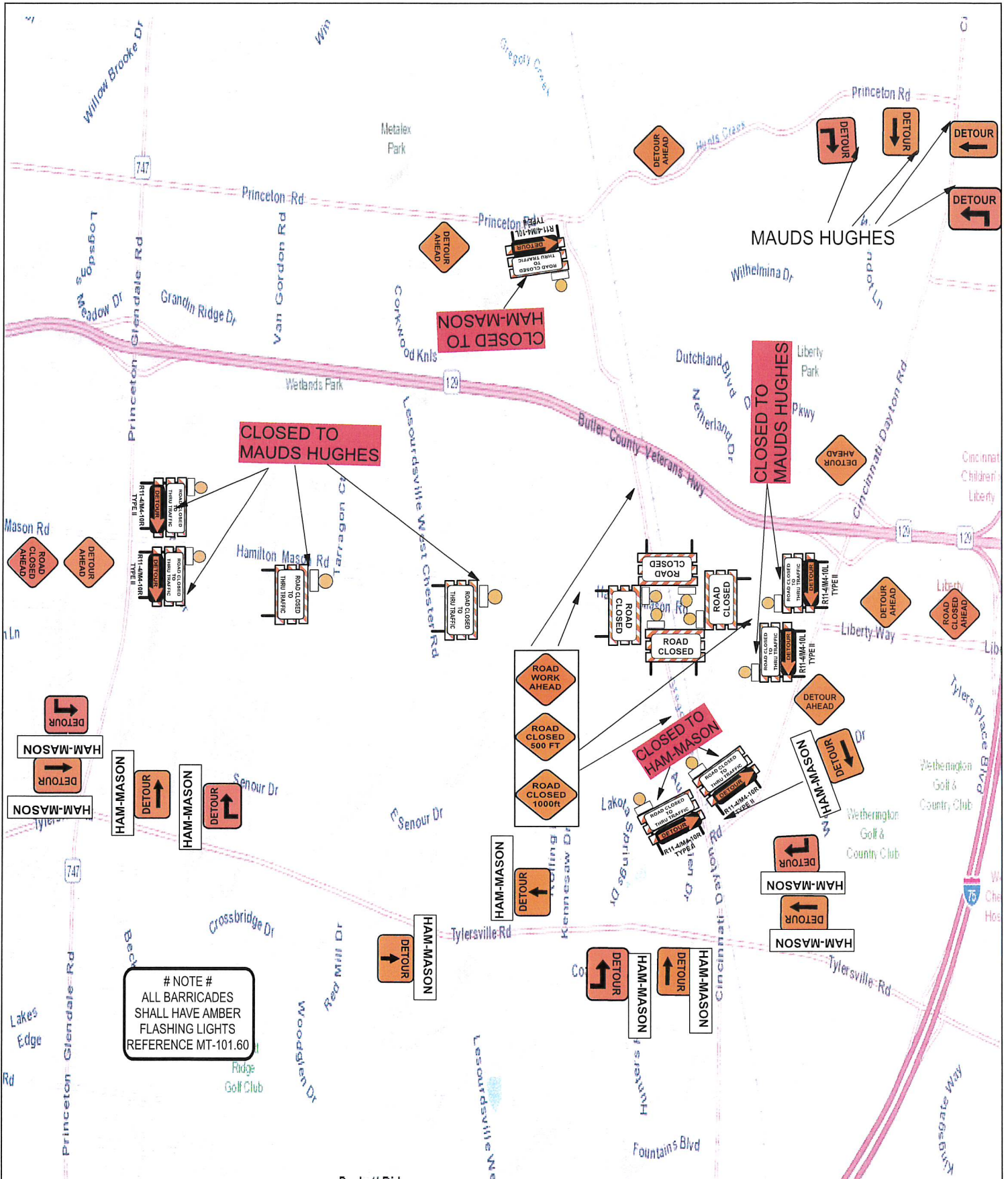

NOTE #
 ALL BARRICADES
 SHALL HAVE AMBER
 FLASHING LIGHTS
 REFERENCE MT-101.60

	Date: 6/13/2019 Author: Jester Project: Hamilton Mason Rd #7.491
	Comments: Mot # NOT TO SCALE #



ADDENDUM #2						
BUT-TR21-7.52, HAMILTON MASON AND MAUDS HUGHES ROAD INTERSECTION IMPROVEMENT						
Contract 2022-11 - Schedule of Prices						
3/3/2022						
Line	Number	Description	Unit	Contract Quantity	Unit Price	Total
1-ROADWAY						
1	201E11000	CLEARING AND GRUBBING	LS	1		
2	202E11004	STRUCTURE REMOVED Existing 5.5' x 4' Culvert	EACH	1		
3	202E20010	HEADWALL REMOVED	EACH	2		
4	202E23000	PAVEMENT REMOVED	SY	4,186		
5	202E30000	WALK REMOVED	SF	254		
6	202E32000	CURB REMOVED	FT	142		
7	202E32500	CURB AND GUTTER REMOVED	FT	126		
8	202E35100	PIPE REMOVED, 24" AND UNDER	FT	173		
9	202E53100	MAILBOX REMOVED	EACH	2		
10	202E58100	CATCH BASIN REMOVED	EACH	1		
11	202E58500	CATCH BASIN ABANDONED	EACH	1		
12	202E70000	SPECIAL - FILL AND PLUG EXISTING CONDUIT 18"	FT	137		
13	203E10000	EXCAVATION	CY	6,148		
14	203E20000	EMBANKMENT	CY	2,522		
15	204E13000	EXCAVATION OF SUBGRADE	CY	88		
16	204E30020	GRANULAR MATERIAL, TYPE C	CY	88		
17	204E45000	PROOF ROLLING	HOUR	4		
18	206E10500	CEMENT	TON	173		
19	206E11000	CURING COAT	SY	2,217		
20	206E15010	CEMENT STABILIZED SUBGRADE, 12 INCHES DEEP	SY	7,390		
21	206E30000	MIXTURE DESIGN FOR CHEMICALLY STABILIZED SOILS	LS	1		
22	608E12000	5" CONCRETE WALK	SF	804		
23	608E52000	CURB RAMP	SF	121		
24	623E40500	REFERENCE MONUMENT	EACH	11		
25	638E10500	FIRE HYDRANT REMOVED AND RESET	EACH	1		
26	878E25000	INSPECTION AND COMPACTION TESTING OF UNBOUND MATERIALS	LS	1		
153	202E56001	BUILDING DEMOLISHED, AS PER PLAN Parcel D2010-017.000-013 / D2010-017.000-012	LS	1		
154	202E56001A	BUILDING DEMOLISHED, AS PER PLAN Parcel D2010-017.000-011	LS	1		
					TOTAL: ROADWAY	
2-EROSION CONTROL						
27	601E32000	ROCK CHANNEL PROTECTION, TYPE A WITH FILTER	CY	14		

BUT-TR21-7.52, HAMILTON MASON AND MAUDS HUGHES ROAD INTERSECTION IMPROVEMENT						
Contract 2022-11 - Schedule of Prices						
3/3/2022						
Line	Number	Description	Unit	Contract Quantity	Unit Price	Total
28	601E32100	ROCK CHANNEL PROTECTION, TYPE B WITH FILTER	CY	3		
29	659E00100	SOIL ANALYSIS TEST	EACH	2		
30	659E00300	TOPSOIL 4"	CY	965		
31	659E10001	SEEDING AND MULCHING, AS PER PLAN	SY	6,028		
32	659E14000	REPAIR SEEDING AND MULCHING	SY	301		
33	659E15000	INTER-SEEDING	SY	301		
34	659E20000	COMMERCIAL FERTILIZER	TON	0.82		
35	659E31000	LIME	ACRE	1.25		
36	659E35000	WATER	MGAL	33		
37	670E00500	SLOPE EROSION PROTECTION	SY	2,658		
38	832E15000	STORM WATER POLLUTION PREVENTION PLAN This item includes all costs associated with the development, implementation, inspection and the required documentation of a Storm Water Pollution Prevention Plan for the Project described in this Contract. all of the specifications and requirements of ODOT supplemental specification 832 shall apply.	LS	1		
39	832E15002	STORM WATER POLLUTION PREVENTION INSPECTIONS	LS	1		
40	832E15010	STORM WATER POLLUTION PREVENTION INSPECTION SOFTWARE	LS	1		
41	832E30000	EROSION CONTROL This item is for the installation of Storm Water BMPS as defined in appendix "F" of ODOT supplemental specifications 832. The Contractor shall enter \$1.00 in the unit price column and \$45,000.00 in the total column. If the Contractor neglects to enter the correct figure(s) the Contractors bid will be corrected and the process for "Mistake In Bid" shall follow. No work will be recognized or paid under this item unless agreed upon and approved by an authorized representative of the Butler County Engineer's Office.	EACH	45,000		
149	691E00500	SPECIAL - HERBICIDE FOR WEED CONTROL	SY	6,081		
				TOTAL: EROSION CONTROL		
3-DRAINAGE						
42	602E20000	CONCRETE MASONRY	CY	2		
43	605E11100	6" SHALLOW PIPE UNDERDRAINS	FT	296		
44	605E14000	6" BASE PIPE UNDERDRAINS	FT	3,965		
45	611E00510	6" CONDUIT, TYPE F FOR UNDERDRAIN OUTLETS	FT	155		
47	611E04600	12" CONDUIT, TYPE C	FT	42		
48	611E05700	15" CONDUIT, TYPE A 706.01	FT	53		
51	611E07600	18" CONDUIT, TYPE C	FT	127		
52	611E08700	21" CONDUIT, TYPE A 706.01	FT	46		
54	611E20700	48" CONDUIT, TYPE A	FT	83		
55	611E98151	CATCH BASIN, NO. 3, AS PER PLAN	EACH	3		
56	611E98181	CATCH BASIN, NO. 3A, AS PER PLAN	EACH	13		

BUT-TR21-7.52, HAMILTON MASON AND MAUDS HUGHES ROAD INTERSECTION IMPROVEMENT

Contract 2022-11 - Schedule of Prices

3/3/2022

Line	Number	Description	Unit	Contract Quantity	Unit Price	Total
57	611E98510	CATCH BASIN, NO. 2-3	EACH	4		
58	611E98600	CATCH BASIN, NO. 2-6 As Per Plan	EACH	1		
59	611E99574	MANHOLE, NO. 3	EACH	2		
60	611E99910	DRAINAGE STRUCTURE, MISC.: 60" Conduit, Type C, As Per Plan	FT	13		
150	611E97011	SLOTTED DRAIN, TYPE 2, AS PER PLAN 6"	FT	33		
152	611E01500	6" CONDUIT, TYPE F	FT	10		
					TOTAL: DRAINAGE	
3-PAVEMENT						
61	254E01000	PAVEMENT PLANING, ASPHALT CONCRETE	SY	2,585		
62	301E46000	ASPHALT CONCRETE BASE, PG64-22	CY	1,723		
63	301E46000A	ASPHALT CONCRETE BASE, PG64-22, VARIABLE DEPTH	CY	179		
64	304E20000	AGGREGATE BASE	CY	1,313		
65	407E20000	NON-TRACKING TACK COAT	GAL	1,586		
66	441E50101	ASPHALT CONCRETE SURFACE COURSE, TYPE 1, (448), AS PER PLAN PG64-22	CY	430		
67	441E50300	ASPHALT CONCRETE INTERMEDIATE COURSE, TYPE 2, (448)	CY	282		
68	441E50300A	ASPHALT CONCRETE INTERMEDIATE COURSE, TYPE 2, (448), VARIABLE DEPTH	CY	90		
69	609E12000	COMBINATION CURB AND GUTTER, TYPE 2	FT	2,212		
70	609E26000	CURB, TYPE 6	FT	37		
					TOTAL: PAVEMENT	
4-WATER WORK						
71	638E00604	6" WATER MAIN DUCTILE IRON PIPE ANSI CLASS 53, PUSH-ON JOINTS AND FITTINGS	FT	16		
72	638E01804	10" WATER MAIN DUCTILE IRON PIPE ANSI CLASS 53, PUSH-ON JOINTS AND FITTINGS	FT	502		
73	638E04800	3/4" COPPER SERVICE BRANCH	FT	30		
74	638E07608	VALVE BOX	EACH	1		
76	638E09900	16" X 10" TAPPING SLEEVE, VALVE AND VALVE BOX	EACH	1		
77	638E10200	6" FIRE HYDRANT	EACH	1		
78	638E20536	SPECIAL - 6" GATE VALVE	EACH	1		
79	638E20762	SPECIAL - FIRE HYDRANT SERVICE LINE EXTENDED AND ADJUSTED TO GRADE	EACH	1		
80	638E98000	WATER WORK, MISC.: 10" x 6" Anchor Tee	EACH	2		
81	638E98000A	WATER WORK, MISC.: 10" x 8" Reducer	EA	1		
146	638E10480	FIRE HYDRANT REMOVED	EACH	1		
147	638E20880	SPECIAL - CUT AND PLUG EXISTING 8" WATER LINE	EACH	1		

BUT-TR21-7.52, HAMILTON MASON AND MAUDS HUGHES ROAD INTERSECTION IMPROVEMENT

Contract 2022-11 - Schedule of Prices

3/3/2022

Line	Number	Description	Unit	Contract Quantity	Unit Price	Total
148	638E98000B	WATER WORK MISC: Connect to existing 8" water	EA	1		
155	638E900001	ABANDON WATER SERVICE AT MAIN	EA	2		
					TOTAL: WATER WORK	

5-TRAFFIC CONTROL

82	621E00100	RPM Bidirectional	EACH	92		
83	630E03100	GROUND MOUNTED SUPPORT, NO. 3 POST	FT	154		
84	630E80100	SIGN, FLAT SHEET	SF	149		
85	630E80500	SIGN, DOUBLE FACED, STREET NAME	EACH	2		
86	630E84900	REMOVAL OF GROUND MOUNTED SIGN AND DISPOSAL	EACH	13		
87	630E85100	REMOVAL OF GROUND MOUNTED SIGN AND REERECTION	EACH	1		
88	630E86002	REMOVAL OF GROUND MOUNTED POST SUPPORT AND DISPOSAL	EACH	9		
89	644E00100	EDGE LINE, 4"	MILE	0.52		
90	644E00300	CENTER LINE	MILE	0.61		
91	644E00400	CHANNELIZING LINE, 8"	FT	1,325		
92	644E00500	STOP LINE	FT	183		
93	644E00700	TRANSVERSE/DIAGONAL LINE	FT	221		
94	644E01300	LANE ARROW	EACH	19		
95	646E10200	CENTER LINE	MILE	0.01		
96	646E10300	CHANNELIZING LINE, 8"	FT	152		
97	646E20300	LANE ARROW	EACH	3		
98	646E50000	REMOVAL OF PAVEMENT MARKING Lane Arrow	EACH	1		
99	646E50100	REMOVAL OF PAVEMENT MARKING Channelizing Line	FT	152		
100	646E50300	REMOVAL OF PAVEMENT MARKING Edge Line	MILE	0.01		
					TOTAL: TRAFFIC CONTROL	

6-TRAFFIC SIGNALS

101	625E18510	BRACKET ARM, 30'	EACH	2		
102	625E23304	NO. 8 AWG 600 VOLT DISTRIBUTION CABLE	FT	693		
103	625E23400	NO. 10 AWG POLE AND BRACKET CABLE	FT	140		
104	625E25506	CONDUIT, 3", 725.052	FT	190		
105	625E25606	CONDUIT, 4", 725.052	FT	27		
106	625E25900	CONDUIT, JACKED OR DRILLED 725.052, 4"	FT	147		
107	625E26253	LUMINAIRE, CONVENTIONAL, SOLID STATE (LED), AS PER PLAN Type III	EACH	2		
108	625E29002	TRENCH, 24" DEEP	FT	210		

BUT-TR21-7.52, HAMILTON MASON AND MAUDS HUGHES ROAD INTERSECTION IMPROVEMENT						
Contract 2022-11 - Schedule of Prices						
3/3/2022						
Line	Number	Description	Unit	Contract Quantity	Unit Price	Total
109	625E30706	PULL BOX, 725.08, 24"	EACH	4		
110	625E32000	GROUND ROD	EACH	5		
111	630E79100	SIGN HANGER ASSEMBLY, MAST ARM	EACH	6		
112	632E05006	VEHICULAR SIGNAL HEAD, (LED), 3-SECTION, 12" LENS, 1-WAY, POLYCARBONATE	EACH	11		
113	632E05064	VEHICULAR SIGNAL HEAD, (LED), 4-SECTION, 12" LENS, 1-WAY, POLYCARBONATE	EACH	2		
114	632E25000	COVERING OF VEHICULAR SIGNAL HEAD	EACH	13		
115	632E40500	SIGNAL CABLE, 5 CONDUCTOR, NO. 14 AWG	FT	1,123		
116	632E40700	SIGNAL CABLE, 7 CONDUCTOR, NO. 14 AWG	FT	2,510		
117	632E64010	SIGNAL SUPPORT FOUNDATION	EACH	4		
118	632E68100	POWER CABLE, 1 CONDUCTOR, NO. 6 AWG	FT	100		
119	632E70001	POWER SERVICE, AS PER PLAN	EACH	1		
120	632E72100	SIGNAL SUPPORT, TYPE TC-81.22, DESIGN 2	EACH	2		
121	632E78368	COMBINATION SIGNAL SUPPORT, TYPE TC-12.31 DESIGN 10 POLE, WITH MAST ARMS TC-81.22 DESIGN 13 AND DESIGN 12	EACH	1		
122	632E79151	COMBINATION SIGNAL SUPPORT, TYPE TC-81.22, DESIGN 14, AS PER PLAN	EA	1		
123	633E65511	CABINET, TYPE TS-2, AS PER PLAN	EACH	1		
124	633E67100	CABINET FOUNDATION	EACH	1		
125	633E67200	CONTROLLER WORK PAD	EACH	1		
126	633E75001	UNINTERRUPTIBLE POWER SUPPLY (UPS), 1000 WATT, AS PER PLAN	EACH	1		
127	809E69101	STOP LINE RADAR DETECTION, AS PER PLAN	EACH	6		
128	809E69123	ATC V6.24 CONTROLLER, AS PER PLAN	EACH	1		
129	809E69201	EMERGENCY VEHICLE PREEMPTION, AS PER PLAN	EACH	1		
130	809E69210	PREEMPT RECEIVING UNIT	EACH	1		
131	809E69220	PREEMPT DETECTOR CABLE	FT	147		
132	809E69230	PREEMPT PHASE SELECTOR	EACH	1		
133	809E69240	PREEMPT CONFIRMATION LIGHT LED	EACH	6		
				TOTAL: TRAFFIC SIGNALS		
7-MAINTENANCE OF TRAFFIC						
134	616E10000	WATER	MGAL	27		
				TOTAL: MAINTENANCE OF TRAFFIC		
8-INCIDENTALS						
135	614E11000	MAINTAINING TRAFFIC	LS	1		
136	619E16010	FIELD OFFICE, TYPE B	MNTH	6		

BUT-TR21-7.52, HAMILTON MASON AND MAUDS HUGHES ROAD INTERSECTION IMPROVEMENT						
Contract 2022-11 - Schedule of Prices						
3/3/2022						
Line	Number	Description	Unit	Contract Quantity	Unit Price	Total
137	623E10000	CONSTRUCTION LAYOUT STAKES AND SURVEYING	LS	1		
138	624E10000	MOBILIZATION	LS	1		
139	802E00001	PREMIUM ON INDUSTRIAL INSURANCE	LS	1		
140	802E00002	PREMIUM ON BID BOND	LS	1		
141	802E00003	CONTINGENCIES The Contractor shall enter \$1.00 in the unit price column and \$45,000.00 in the total column. If the Contractor neglects to enter the correct figure(s), the Contractor's bid will be corrected and the process for "Mistake in Bid" shall follow. This item will be used in the event that there are change orders in the Contract. No work will be paid or recognized under this item unless agreed upon in writing by an authorized representative of the Butler County Engineer's Office.	EA	45,000		
TOTAL: INCIDENTALS						
ALTERNATE #1						
46	611E04400	12" CONDUIT, TYPE B	FT	676		
49	611E05900	15" CONDUIT, TYPE B	FT	373		
50	611E07400	18" CONDUIT, TYPE B	FT	353		
53	611E08900	21" CONDUIT, TYPE B	FT	87		
TOTAL: ALTERNATE #1						
ALTERNATE #2						
142	611E04400	12" CONDUIT, TYPE B LSM Backfill	FT	676		
143	611E05900	15" CONDUIT, TYPE B LSM Backfill	FT	373		
144	611E07400	18" CONDUIT, TYPE B LSM Backfill	FT	353		
145	611E08900	21" CONDUIT, TYPE B LSM Backfill	FT	87		
TOTAL: ALTERNATE #2						
TOTAL: BASE BID / ALTERNATE #1						
TOTAL: BASE BID / ALTERNATE #2						